

# 勘测定界图

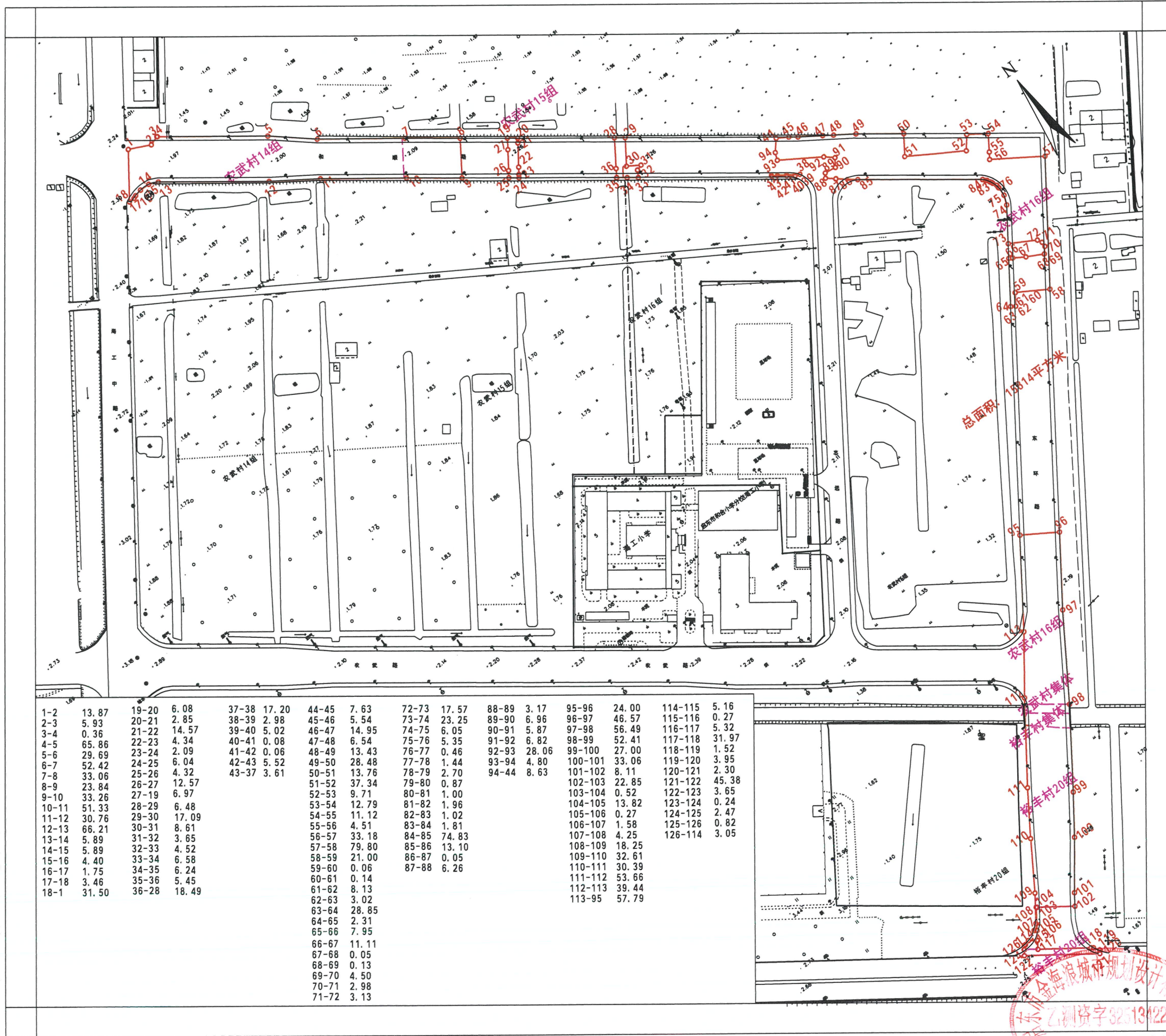

1-2	13.87	19-20	6.08	37-38	17.20	44-45	7.63	72-73	17.57	88-89	3.17	95-96	24.00	114-115	5.16
2-3	5.93	20-21	2.85	38-39	2.98	45-46	5.54	73-74	23.25	89-90	6.96	96-97	46.57	115-116	0.27
3-4	0.36	21-22	14.57	39-40	5.02	46-47	14.95	74-75	6.05	90-91	5.87	97-98	56.49	116-117	5.32
4-5	65.86	22-23	4.34	40-41	0.08	47-48	6.54	75-76	5.35	91-92	6.82	98-99	52.41	117-118	31.97
5-6	29.69	23-24	2.09	41-42	0.06	48-49	13.43	76-77	0.46	92-93	28.06	99-100	27.00	118-119	1.52
6-7	52.42	24-25	6.04	42-43	5.52	49-50	28.48	77-78	1.44	93-94	4.80	100-101	33.06	119-120	3.95
7-8	33.06	25-26	4.32	43-37	3.61	50-51	13.76	78-79	2.70	94-44	8.63	101-102	8.11	120-121	2.30
8-9	23.84	26-27	12.57			51-52	37.34	79-80	0.87			102-103	22.85	121-122	45.38
9-10	33.26	27-19	6.97			52-53	9.71	80-81	1.00			103-104	0.52	122-123	3.65
10-11	51.33	28-29	6.48			53-54	12.79	81-82	1.96			104-105	13.82	123-124	0.24
11-12	30.76	29-30	17.09			54-55	11.12	82-83	1.02			105-106	0.27	124-125	2.47
12-13	66.21	30-31	8.61			55-56	4.51	83-84	1.81			106-107	1.58	125-126	0.82
13-14	5.89	31-32	3.65			56-57	33.18	84-85	74.83			107-108	4.25	126-114	3.05
14-15	5.89	32-33	4.52			57-58	79.80	85-86	13.10			108-109	18.25		
15-16	4.40	33-34	6.58			58-59	21.00	86-87	0.05			109-110	32.61		
16-17	1.75	34-35	6.24			59-60	0.06	87-88	6.26			110-111	30.39		
17-18	3.46	35-36	5.45			60-61	0.14					111-112	53.66		
18-1	31.50	36-28	18.49			61-62	8.13					112-113	39.44		
						62-63	3.02					113-95	57.79		
						63-64	28.85								
						64-65	2.31								
						65-66	7.95								
						66-67	11.11								
						67-68	0.05								
						68-69	0.13								
						69-70	4.50								
						70-71	2.98								
						71-72	3.13								

启东市金海浪城市规划设计有限公司

