

# 勘测定界图

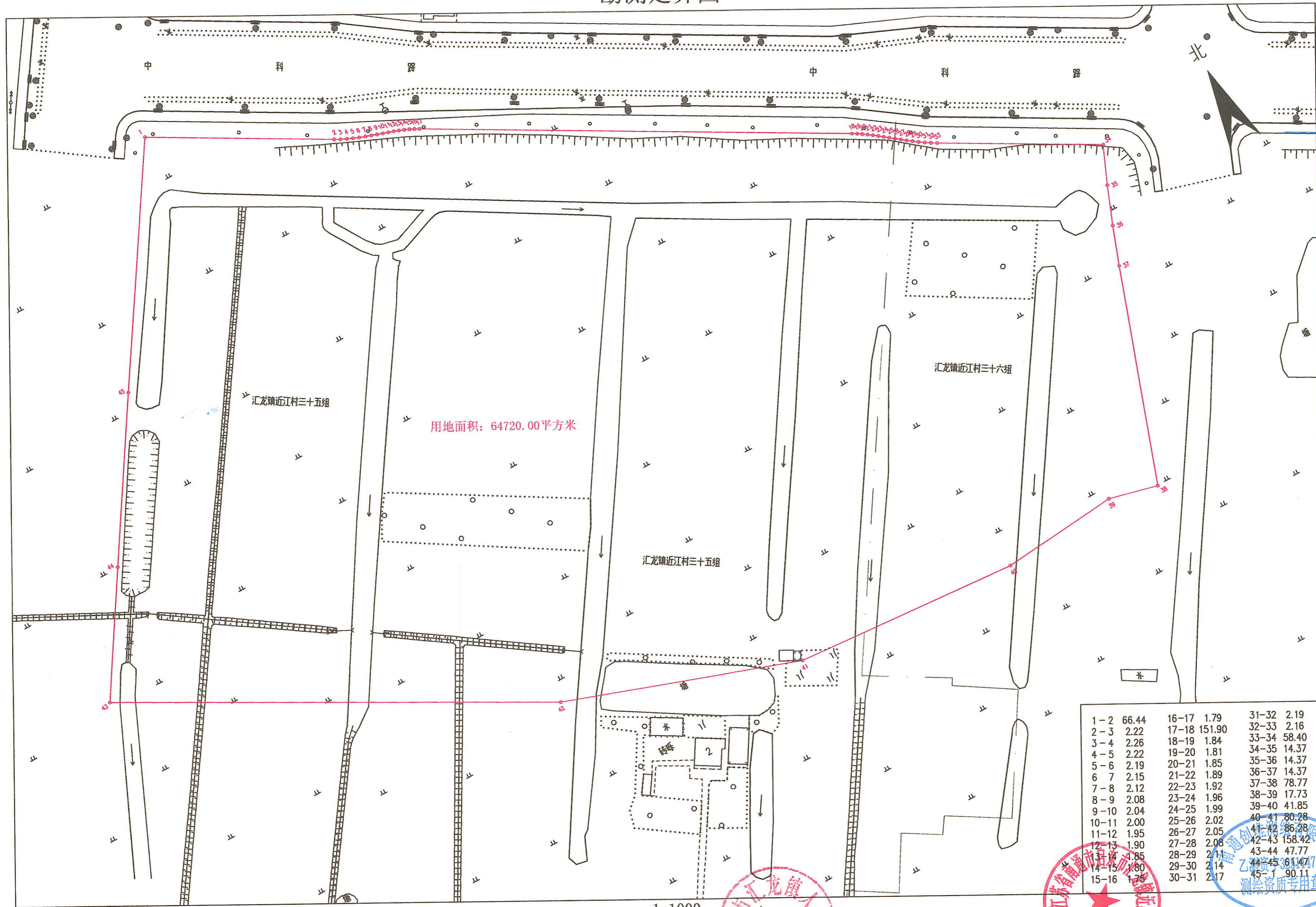

1-2	66.44	16-17	1.79	31-32	2.19
2-3	2.22	17-18	151.90	32-33	2.16
3-4	2.26	18-19	1.84	33-34	58.40
4-5	2.22	19-20	1.81	34-35	14.37
5-6	2.19	20-21	1.85	35-36	14.37
6-7	2.15	21-22	1.89	36-37	14.37
7-8	2.12	22-23	1.92	37-38	78.77
8-9	2.08	23-24	1.96	38-39	17.73
9-10	2.04	24-25	1.99	39-40	41.85
10-11	2.00	25-26	2.02	40-41	80.28
11-12	1.95	26-27	2.05	41-42	86.28
12-13	1.90	27-28	2.08	42-43	158.42
13-14	1.85	28-29	2.11	43-44	47.77
14-15	1.80	29-30	2.14	44-45	361.47
15-16	1.75	30-31	2.17	45-1	90.11

